

This print is furnished with the understanding that it will be used as a record or to identify or inspect parts and for other information purposes and not to manufacture or procure the manufacture of the parts shown in this print from any source other than CEMCOLIFT Inc. except with the prior written consent of CEMCOLIFT Inc.

| LVL | ECN         | DATE     | DESCRIPTION  | BY        |
|-----|-------------|----------|--|-----------|
| A   | N/A         | 05.09.01 | INITIAL RELEASE  | SAM       |
| B   | JEFF GRISAN | 11/14/05 | ALL PARTS DRAWN TO SCALE AND LABELED, INSERTED NEW TITLE BLOCK | MLJ<br>JG |
|     |             |          |  |           |

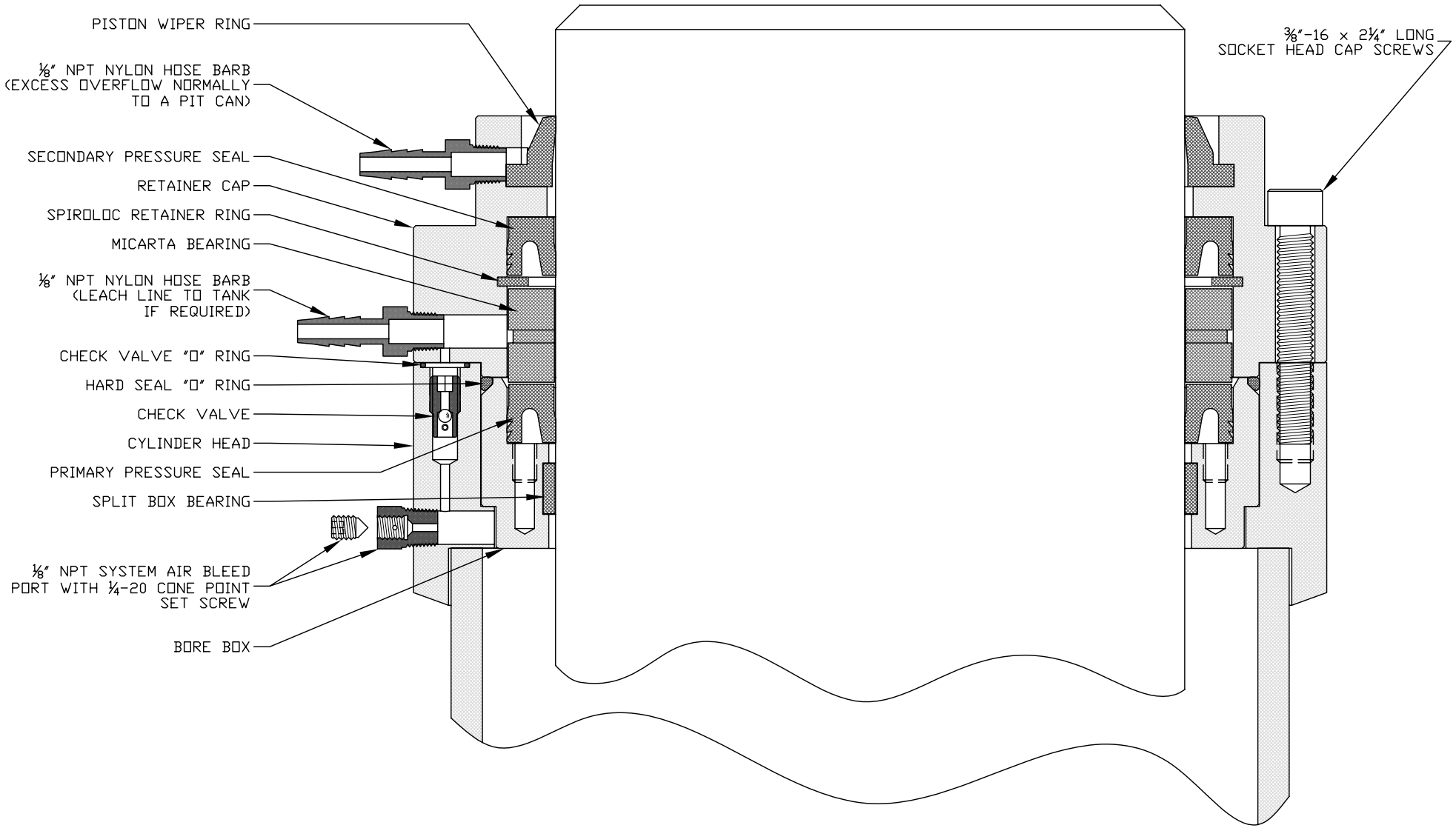

|                                 |                  |
|---------------------------------|------------------|
| TOLER. 3PL. ± .005"             | FRACTION ± 1/32" |
| TOLER. 2PL. ± .015"             | ANGLE ± 2'       |
| MATERIAL:                       |                  |
| N/A                             |                  |
| FILE: ..\PRODENG\SK\SK10017.DWG |                  |

**CEMCO**  
**LIFT**  
ELEVATOR SYSTEMS

2801 TOWNSHIP LINE RD. HATFIELD, PA 19440-0500

|  |                |            |                  |              |
|--|----------------|------------|------------------|--------------|
| TITLE: CROSS SECTION<br>CEMCO 2 SEAL WELDED HEAD |                |            |                  |              |
| DRAWN: SAM                                       | DATE: 05.09.01 | SIZE: A    | DWG NO. SK-10017 | REV. B       |
| CHECKED:   | DATE:          | SCALE: NTS |                  | SHEET 1 OF 1 |

## Packing Procedures

### 2 Seal weld-on head

- Remove socket head cap screws
- Remove retainer cap
- Remove both O rings
- Remove primary seal from bore box-using seal puller or similar device
- Remove bore box using 2 tapped holes on face of bore box
- Remove split box bearing from bore box
- From retainer cap – remove piston wiper ring
- Turn retainer cap upside down and remove micarta bearing
- Remove spiroloc retainer ring
- Remove secondary pressure seal

### Installing new packing

- Replace piston wiper ring in retainer cap
- Turn retainer cap upside down
- Insert secondary pressure seal –**lettering down** into retainer cap
- Install spiroloc retainer ring
- Install micarta bearing
- With tapped holes on bore box facing up-install split box bearing into bottom groove of the bore box
- Install primary pressure seal-**lettering up**
- Coat the packing with oil or grease to facilitate replacement of bore box and retainer
- Using bridge plate, or similar device, to push the bore box on top of piston without the seal coming out of bore box
- Push bore box until seated in weld-on head-slightly below head height
- Insert large O-ring in beveled groove between bore box and cylinder head
- Insert small O-ring on face of weld-on head above ball check valve
- Turn retainer ring wiper side up and slide onto top of piston
- Align pin – install socket head cap screws and tighten